

**ANZSNM  
ASM 2015**  
WHEEL OF CHANGE

17–20 April  
Brisbane Australia



## **Exhibiting at ANZSNM 2015**

### **TRADE EXHIBITION – RAW SPACE OR SHELL SCHEME. \$4900 (incl. GST)**

The ANZSNM 2015 trade exhibition will provide unrivalled delegate exposure not experienced at recent ANZSNM ASM meetings.

The trade exhibition is an integral part of the Conference zone, with all breakout and plenary session rooms opening directly into the trade area. This will also be the location of all daytime catering, maximising opportunities for delegate interaction.

The layout of trade booths\* offers up to ten corner booths, traditional single and double booths as well as space for large custom layouts.

The preliminary schedule is for the exhibition to open Friday 17 April (Welcome Reception), Saturday 18 April, Sunday 19 April and Monday 20 April 2015. Shell Scheme includes;

- Size: one booth 3 metres wide x 3 metres deep x 2.4 metres high,
- Walls: 2500mm high matt anodised aluminium frame with white laminated infills
- Facia: Matt anodised aluminium frame 380mm high with white laminate infill
- Sign: One digital print lettering on white laminate infill per aisle (max. 30 characters) including event logo,
- Lighting: 2x 150-watt spotlights per booth mounted on light track inside fascia, and
- Power: 1x 4amp power point.

#### Networking Opportunities:

- One (1) complimentary Conference registration per booth. This includes attendance at Conference Sessions Saturday 18 to Monday 20 April 2015, attendance at the Welcome Reception Friday 17 April 2015 and Conference Dinner Sunday 19 April 2015.
- Booth staff – one (1) complimentary staff member per booth over and above the one (1) complimentary full registration entitlement above. This entitles staff to attend sessions and full day catering including the Welcome Reception Friday 17 April 2015 but excluding the Conference Dinner Sunday 19 April 2015.

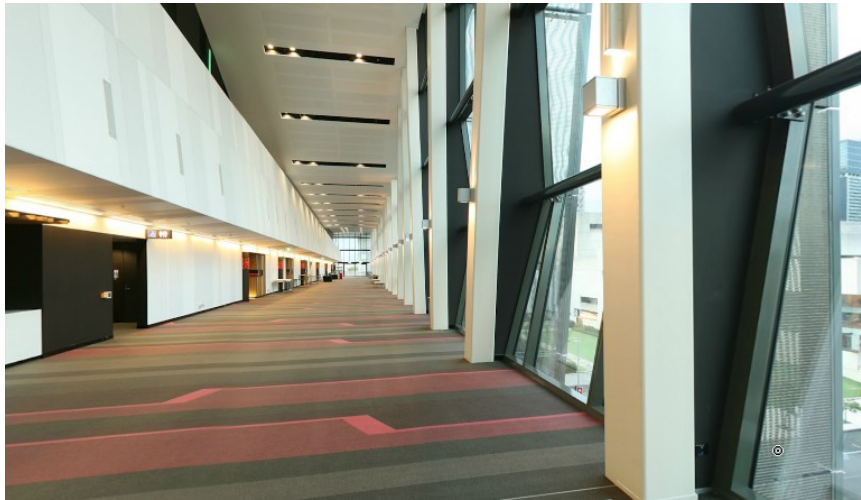
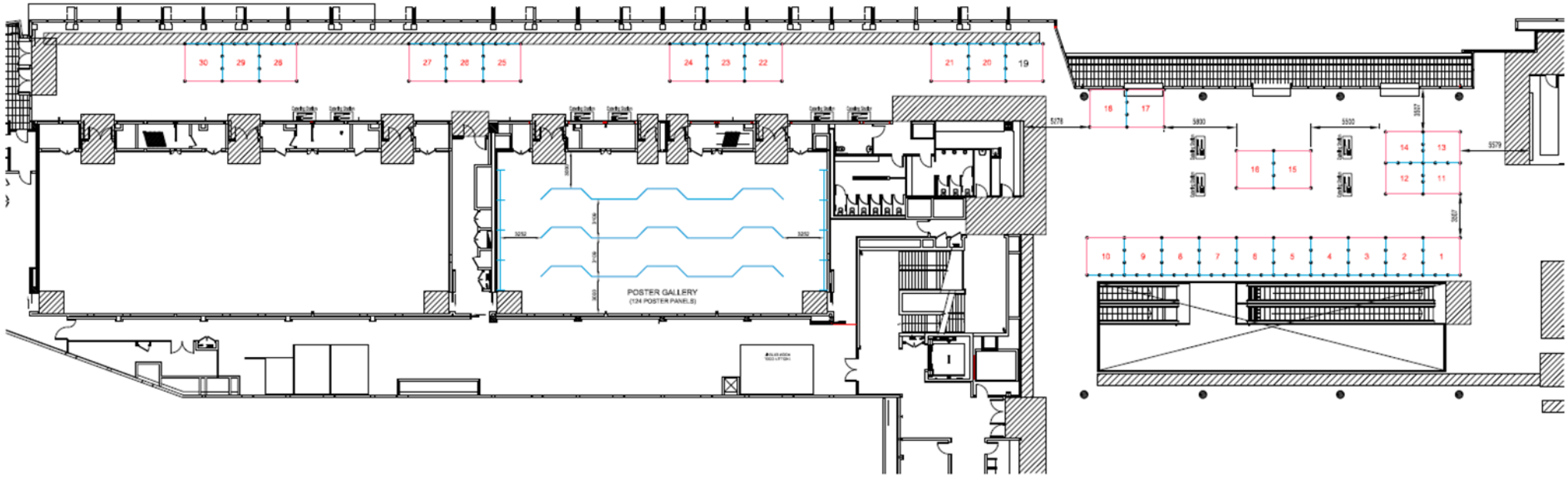

**Booths 19-30**



**Booths 1-18**

*\*Booth and catering layout subject to the approval of the BCEC.*